

Soils Map

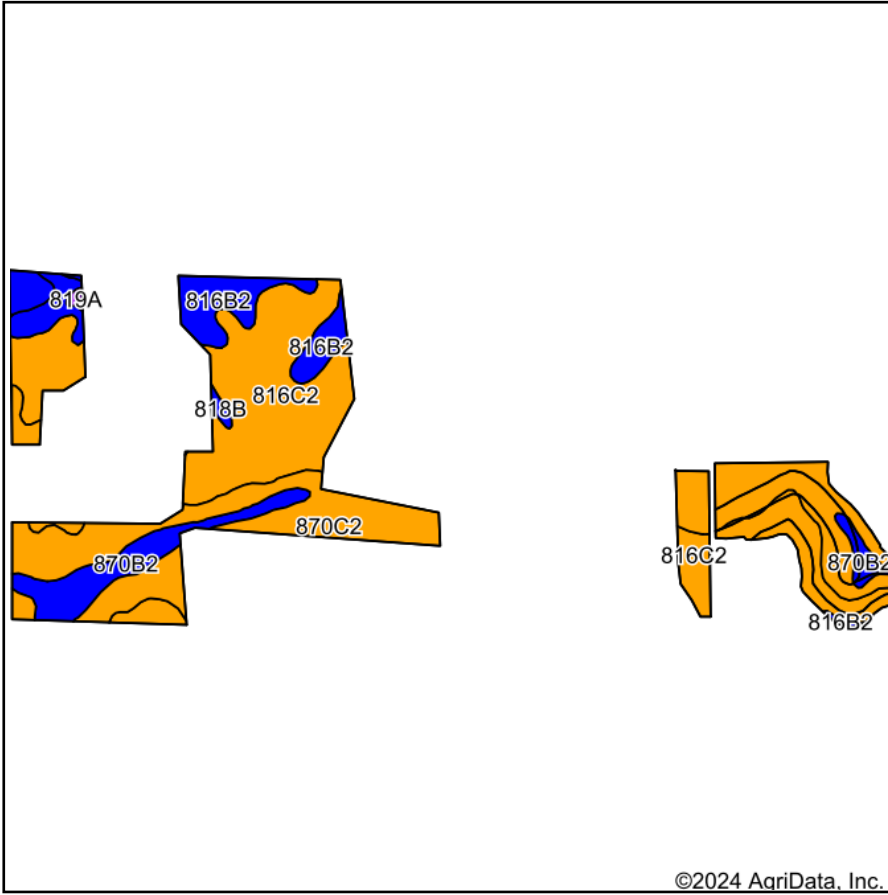

Soils data provided by USDA and NRCS.

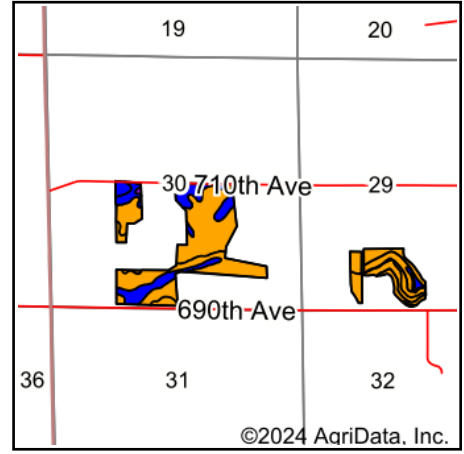

State: **Wisconsin**
 County: **Pierce**
 Location: **30-27N-15W**
 Township: **Spring Lake**
 Acres: **111.99**
 Date: **3/17/2024**



Maps Provided By:



©2024 AgriData, Inc.

Area Symbol: WI093, Soil Area Version: 23

Code	Soil Description	Acres	Percent of field	Non-Irr Class Legend	Non-Irr Class *c	*n NCCPI Overall	*n NCCPI Corn	*n NCCPI Soybeans
816C2	Vlasaty silt loam, dissected, 6 to 12 percent slopes, moderately eroded	46.96	41.9%		IIle	81	81	71
870C2	Santiago silt loam, dissected, 6 to 12 percent slopes, moderately eroded	40.08	35.8%		IIle	66	66	57
816B2	Vlasaty silt loam, dissected, 2 to 6 percent slopes, moderately eroded	10.71	9.6%		Ile	82	82	72
870B2	Santiago silt loam, dissected, 2 to 6 percent slopes, moderately eroded	10.38	9.3%		Ile	65	65	56
818B	Sargeant silt loam, 1 to 6 percent slopes	3.57	3.2%		Ile	79	79	71
819A	Clyde silt loam, 0 to 3 percent slopes	0.29	0.3%		VIw	64	61	64
Weighted Average					2.79	*n 74.1	*n 74.1	*n 64.7

*n: The aggregation method is "Weighted Average using all components"

*c: Using Capabilities Class Dominant Condition Aggregation Method